

Maps reproduced with permission of The Director of Lands. (C) Hong Kong Government.

FILENAME: G:\env\proj\23573\drawings\3rd EIA-V8\Figure\Fig9-2b.dwg

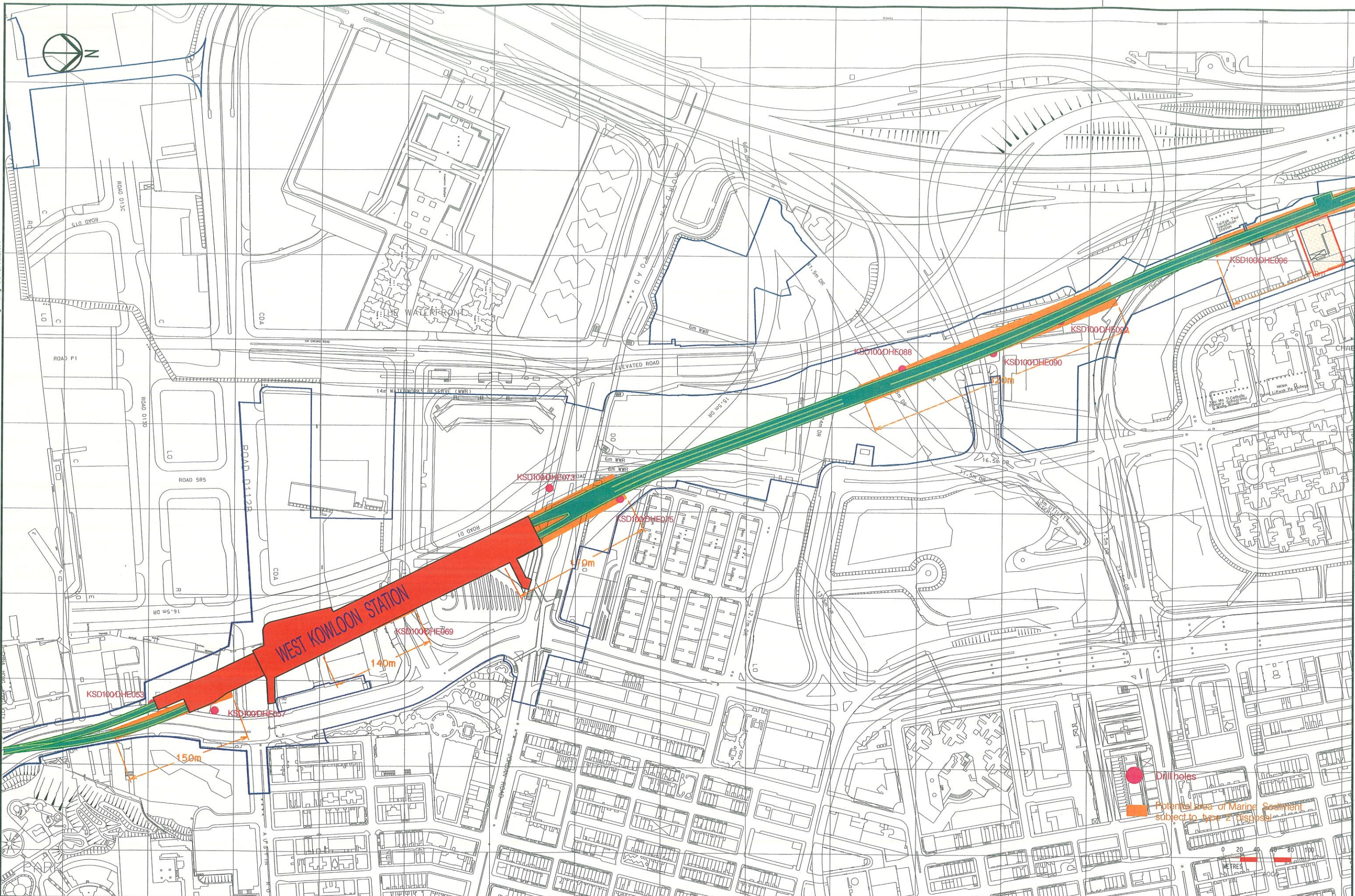

REV	DATE	BY	SUB	APP	DESCRIPTION
△	DEC2003	SW	FC	ST	EIA REPORT
△	NOV2003	SW	FC	ST	EIA REPORT
△	30MAY2003	SW	FC	ST	EIA REPORT
△	7MAR2003	SW	FC	ST	EIA REPORT (2ND DRAFT)
△	11OCT2002	SW	FC	ST	EIA REPORT (1ST DRAFT)

DESIGNED BY	SW
DRAWN BY	RL
CHECKED BY	FC
IN CHARGE	ST
DATE	5 DEC 2003

DESIGNED BY SW
 DRAWN BY RL
 CHECKED BY FC
 IN CHARGE ST
 DATE 5 DEC 2003



New Railway Projects
新鐵路策劃

奧雅納工程顧問
 Ove Arup & Partners Hong Kong Limited



KOWLOON SOUTHERN LINK KSL GSA-5100
EIA & ASSOCIATED SERVICES

AREAS OF MARINE SEDIMENT
SUBJECT TO TYPE II DISPOSAL

CADD FILENAME	KSL GSA-5100
CADD DATE	5 DEC 2003
SCALE	1 : 4000 @ A3
DRAWING NUMBER	FIGURE 9-2-2
SHEET NO	2 OF 3
STAGE CODE	P
REV	E

Maps reproduced with permission of The Director of Lands. (C) Hong Kong Government.

FILENAME: G:\env\project\23573\drawings\3rd EIA-V8\Figure\Figure9-2c.dgn

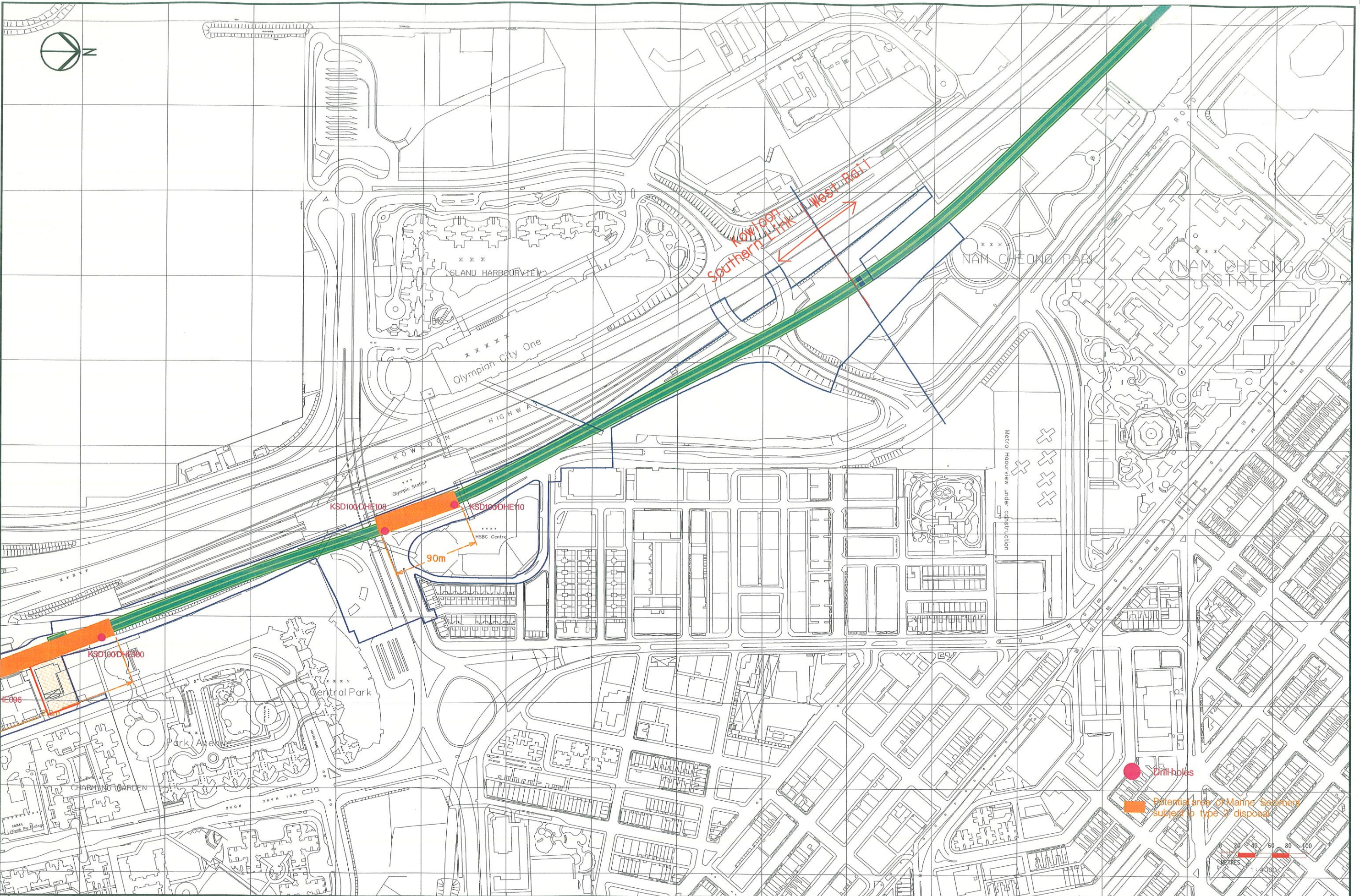

REV	DATE	BY	SUB	APP	DESCRIPTION

REV	DATE	BY	SUB	APP	DESCRIPTION

DESIGNED BY	SW
DRAWN BY	RL
CHECKED BY	FC
IN CHARGE	ST
DATE	5 DEC 2003

New Railway Projects

新鐵路策劃

奧雅納工程顧問

Ove Arup & Partners Hong Kong Limited

KOWLOON SOUTHERN LINK KSL GSA-5100

EIA & ASSOCIATED SERVICES

AREAS OF MARINE SEDIMENT

SUBJECT TO TYPE II DISPOSAL

CADD FILENAME	CADD DATE
SCALE	1 : 4000 @ A3
DRAWING NUMBER	FIGURE 9-2-3
SHEET NO	3 OF 3
STAGE CODE	P
REV	E